



28mm Old West Roof #5

B28-OW-604

Please read these instructions fully before starting construction.

PVA or equivalent glue will be required to stick sections together.

Sand paper can be used to gently clean any joints.

A sharp modelling knife will be required to remove sections from the sprue. Please use knives with due care and remember to cut away from yourself at all times.

During the construction of this model, you may find it convenient to use pegs / elastic bands to hold pieces in place while you allow glue to dry.



Remove the pieces shown above from the sprue.



Glue the support bars through the holes in the roof plate.



Glue the end pieces and ridge bar into place.

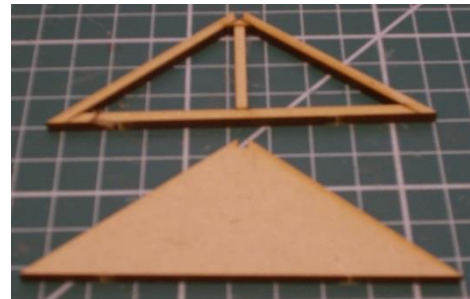

The end "frames"

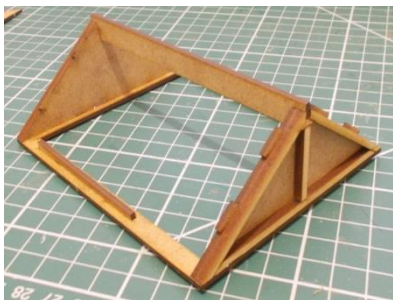

The blank "frame" goes at the end nearest the support bars. The open frame goes in the other end (see pic)

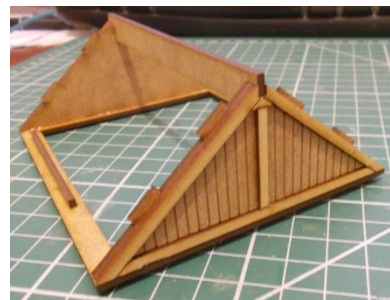

Add the insert pieces into the frame.



Glue the roof pieces into place.

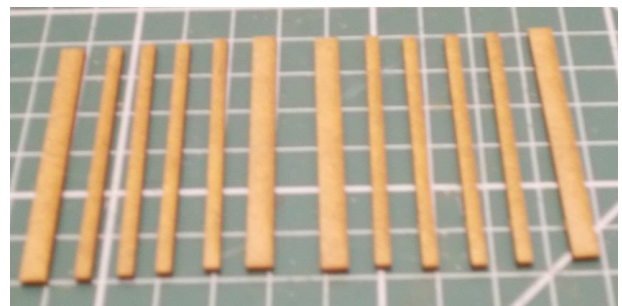

The roof strips.



Glue the strips into place.



The completed roof.